

DUST COVER

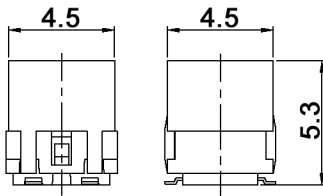

P.C.B. LAYOUT

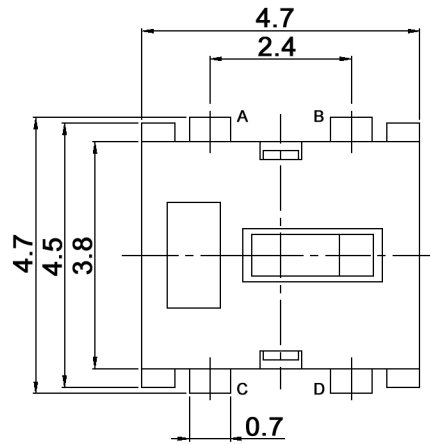
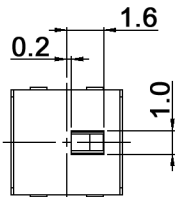
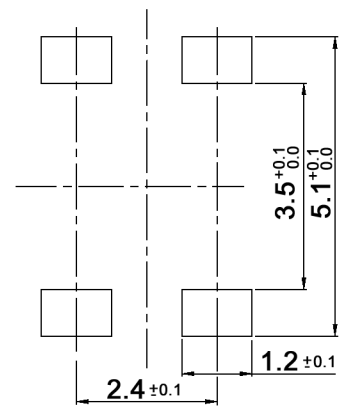

CIRCUIT DIAGRAM

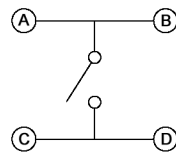

Compliance: RohS II (2011/65/EU)

| | | | | |
|--------------------------|-------|-------|-----------------------|----------------------|
| Tolerances: max. ±0.20mm | | Date | Name | <h1>DTS 312 C-T</h1> |
| | | 11/14 | dr | |
| | | | | |
| | | | | |
| Temperatures | 07/15 | dr | <h2>30 32 21</h2> | Page |
| Material terminal | 01/15 | dr | | 1/2 |
| Modifications | Date | Name | knitter-switch | |

Specifications:

Contact rating: 1mA, 5V DC
Contact resistance: 10hm max.
Insulation resistance: 100MOhm min. at 100V DC for 1 minute +/-5sec.
Dielectric strength: 100V AC (50/60Hz) for 1 minute
Operating temperature: -40°C to +85°C
Storage temperature: -40°C to +85°C
Electrical life: 100 000 cycles min.
Operating force: 40gf max.
Material: Terminal: phosphor bronze, silver plated
 Base: high-temp. thermoplastic PA9T, molded black
 Contact: stainless steel, silver cladding
 Stem / cover: high-temp. thermoplastic LCP, molded black

Soldering conditions:

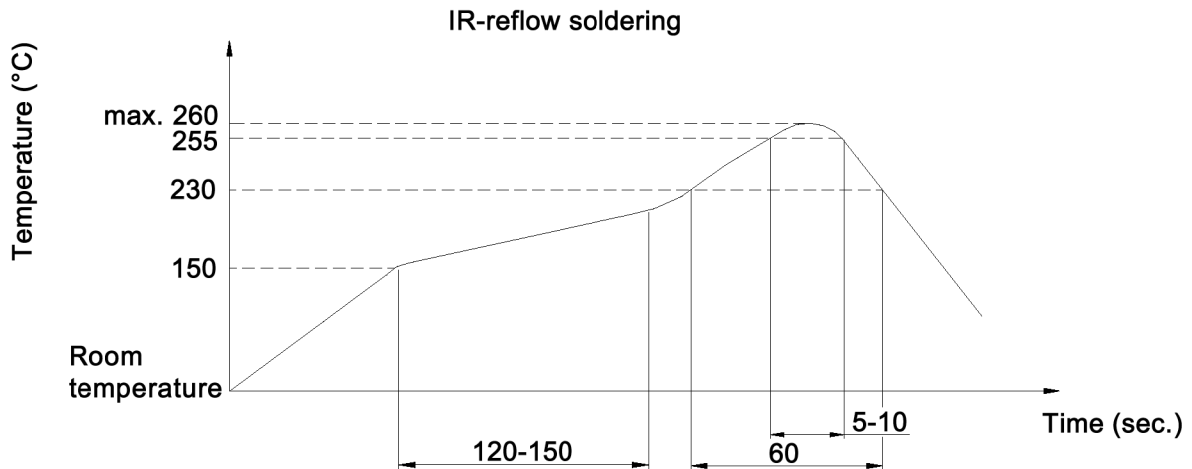

Compliance: RohS II (2011/65/EU)

| | | | | |
|--------------------------|--|-------|-----------------------|--------------------|
| Tolerances: max. ±0.20mm | | Date | Name | DTS 312 C-T |
| | | 11/14 | dr | |
| | | | | |
| | | | | |
| | | | knitter-switch | 30 32 21 |
| Modifications | | Date | Name | Page 2/2 |